

**AN ORDINANCE ANNEXING CERTAIN TERRITORY INTO THE
CORPORATE LIMITS OF THE CITY OF PINSON, ALABAMA**

WHEREAS, **Casey Wiles and Albernice and Patricia Braxton** ("Petitioners"), the owners of the property described hereinafter ("Property"), have filed a written petition with the City Clerk of the City of Pinson stating that they are the owners of the Property; and requesting that the Property be annexed into the City of Pinson; and

WHEREAS, the petition contains an accurate description of the Property and was accompanied by a map of the Property showing its relationship to the corporate limits of the City of Pinson; and

WHEREAS, the Property is contiguous to the corporate limits of the City of Pinson; and

WHEREAS, the Property is not within the corporate limits or the police jurisdiction of any other municipality,

NOW, THEREFORE, BE IT ORDAINED by the City Council of the City of Pinson, Alabama as follows:

That the City Council of the City of Pinson, Alabama, does hereby assent to the annexation of the following described property to the City of Pinson:

1. **Parcels 8-36-1-0-2.001 and 3.001 with irregular descriptions shown on the petition attached herein located at 6369 Red Hollow Road**
2. **Parcel 9-31-2-11-5.000 with irregular description shown on the petition and attached herein located at 6213 Kaley Lane.**

ADOPTED this the 7th day of May, 2015

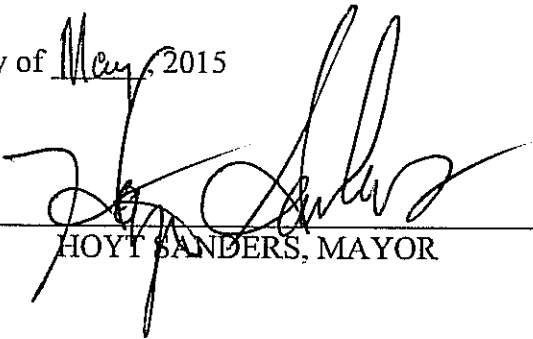
HOYT SANDERS, MAYOR

ATTEST: Marie L, CITY CLERK/TREASURER

CERTIFICATION OF CITY CLERK/TREASURER

STATE OF ALABAMA)

JEFFERSON COUNTY)

I, Marie Turner, City Clerk/Treasurer of the City of Pinson, Alabama, do hereby certify that the above and foregoing is a true and correct copy of an Ordinance duly adopted by the City Council of the City of Pinson, Alabama, on the 7th day of May, 2015

Witness my hand and seal of office this 7th day of May, 2015

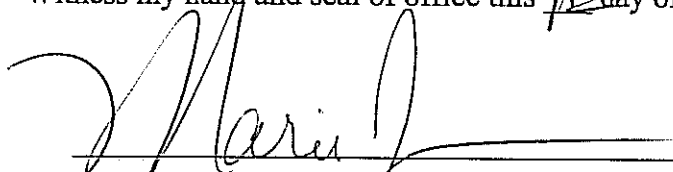
_____, City Clerk/Treasurer

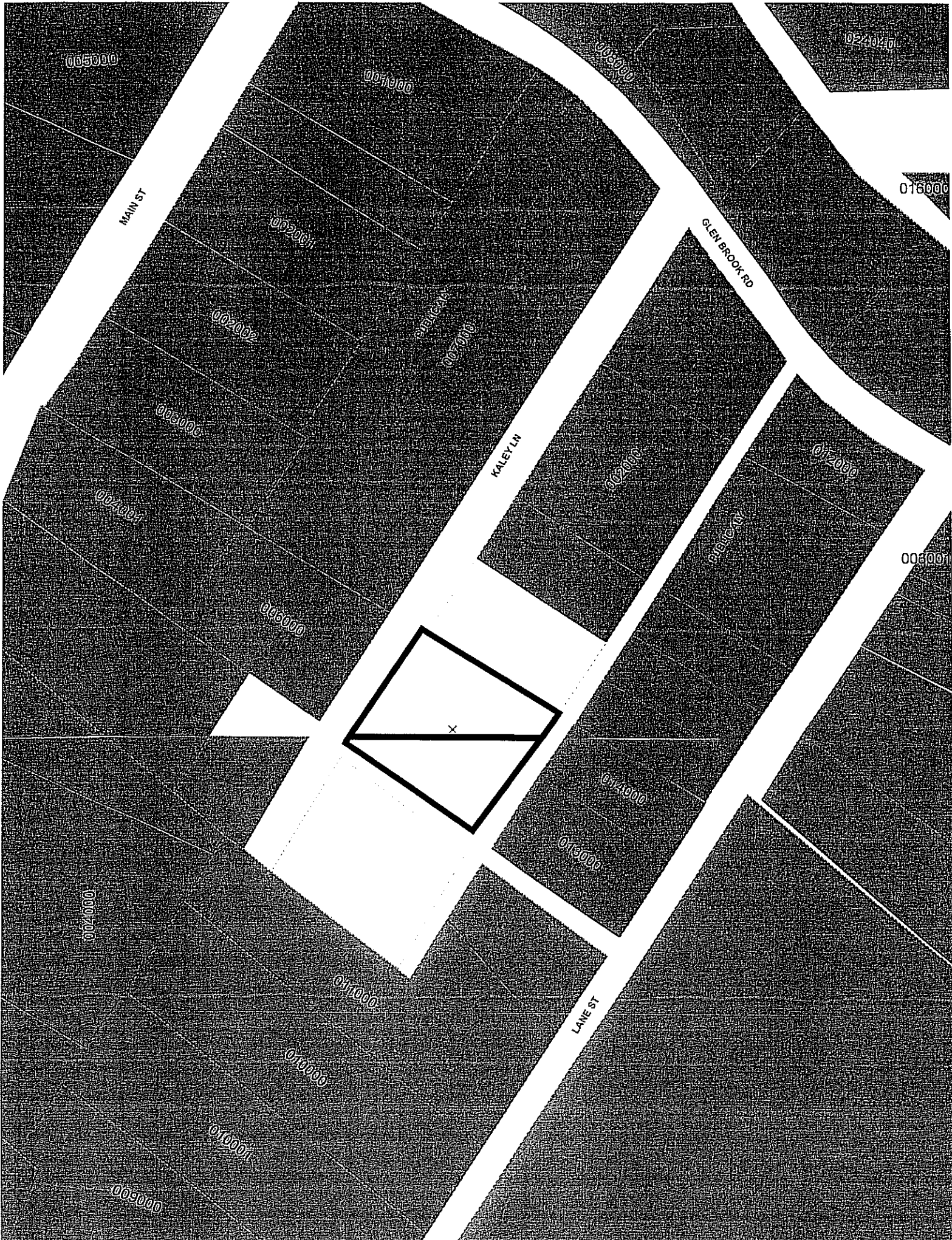

005000

007000

008000

024000

016000

MAIN ST

002001

002002

005001

007001

GLEN BROOK RD

KALEY LN

002000

012000

PLATTE LN

006001

006000

004001

006000

011000

010000

010001

009000

007000

013000

014000

LANE ST